

# R3 MIDWEST HARMONY REGION 3

Regional Convention and Competition  
May 2 – 5, 2024 – Milwaukee, Wisconsin

**March 12, 2024**

**To:** Competing Quartets  
Regional Management Team

**From:** Convention Steering Committee

**RE:** Convention Mailing #3 - Quartet

**Enclosures**

1. Competition Information
2. Traffic Pattern & Information

## Convention Mailing #3 - Quartet

Enclosed you will find important meeting times and locations, and the Quartet traffic pattern. Please review this information carefully.

### Thursday, May 2, 2024

- 7:00 pm Briefing Check in – Wright Ballroom**  
Review forms for changes  
Turn in Cue Sheets (Open Division)  
Receive awards information  
Purse Bags will be distributed (all are required to use Purse Bags)
- 7:30 pm Quartet/Chorus Briefing – Wright Ballroom**  
Contest details will be reviewed so everyone understands the rules and has an opportunity to ask questions  
Briefing should be completed by 8:30 pm

### Friday, May 3, 2024

- 8:30 am Sound Check Chorus & Quartet – Miller High Life Theater**  
All quartets are invited to participate. We will be singing *Send Your Love* and *How We Sang Today*. Renee Porzel will be directing. Once the chorus sound check is complete, we will begin the quartet check. The Four Bettys will be testing the stage
- Quartet Walk-On – Miller High Life Theater**  
Begins after Sound Check is finished  
All quartets will be announced, enter the stage, take a pitch, sing the first few notes of a song and exit
- 4:00 pm Quartet Contest will begin promptly at 4:00 pm**  
2023 Quartet Champions, Stiletto, will perform a swan song following the last contestant. Following their swan song, the Winner's Circle will perform. Details regarding awards will be explained at the Briefing.

### Saturday, May 4, 2024

- 12:00 pm Chorus Contest will begin promptly at 12:00 pm**

**Open Division Contestants** – The stage will have a center stage microphone. Please be sure to indicate your emcee work on your cue sheet so the tech crew will know when to have the microphone on for you. As a reminder, our region only offers white lights on stage.

We hope none of you will have to withdraw from the contest. If your quartet does have to withdraw prior to convention weekend, please contact Competition Services at the Sweet Adelines office in Tulsa. If your quartet needs to withdraw after arriving in Milwaukee, please notify Shelly Hughes immediately. She can be reached via cell phone at 312-209-4533.

**Tickets** – Tickets (Badges) are needed to enter the theater. If you leave the theater, you will be required to show your badge to re-enter. Refer to the Schedule of Events for ticket sales and badge pick up times and locations.

## 2024 Quartet Contest - Region #3

| Contestant Number | Quartet Name                    | Check-in |                     | Load |        | Photo |      | Warm Up |                     | Back |  | ON STAGE |
|-------------------|---------------------------------|----------|---------------------|------|--------|-------|------|---------|---------------------|------|--|----------|
|                   |                                 | Time     | Bus                 | Bus  | Room   | Room  | Room | Stage   | Stage               |      |  |          |
| Welcome           | Emcee                           |          |                     |      |        |       |      |         |                     |      |  | 4:00     |
| MT                | Four Bettys                     | 3:10     | 3:15                |      | 3:35   |       | 3:50 |         | 4:05                |      |  | 4:10     |
| 1                 | Away We Go                      | 3:22     | 3:27                |      | 3:47   |       | 4:02 |         | 4:17                |      |  | 4:22     |
| 2                 | PRISM                           | 3:34     | 3:39                |      | 3:59   |       | 4:14 |         | 4:29                |      |  | 4:34     |
| 3                 | 4Frenz                          | 3:46     | 3:51                |      | 4:11   |       | 4:26 |         | 4:41                |      |  | 4:46     |
| 4                 | Cool Beans                      | 3:58     | 4:03                |      | 4:23   |       | 4:38 |         | 4:53                |      |  | 4:58     |
| 5                 | Whimsy                          | 4:10     | 4:15                |      | 4:35   |       | 4:50 |         | 5:05                |      |  | 5:10     |
| 6                 | Livestream                      | 4:22     | 4:27                |      | 4:47   |       | 5:02 |         | 5:17                |      |  | 5:22     |
|                   | <b>Intermission</b>             |          | <b>Intermission</b> |      |        |       |      |         | <b>Intermission</b> |      |  |          |
|                   | <b>Golden Girl Presentation</b> |          |                     |      |        |       |      |         |                     |      |  | 6:05     |
| 7                 | Humdingers                      | 5:25     | 5:30                |      | 5:50   |       | 6:05 |         | 6:20                |      |  | 6:25     |
| 8                 | On A Whim                       | 5:37     | 5:42                |      | 6:02   |       | 6:17 |         | 6:32                |      |  | 6:37     |
| 9                 | Chordially Yours - OPEN         | 5:49     | 5:54                |      | 6:14   |       | 6:29 |         | 6:44                |      |  | 6:49     |
| 10                | Stiletto                        | 6:03     | 6:08                |      | 6:28   |       | 6:43 |         | 6:58                |      |  | 7:03     |
| 11                | By Request                      | 6:15     | 6:20                |      | 6:40   |       | 6:55 |         | 7:10                |      |  | 7:15     |
| SS                | Stiletto                        | N/A      | N/A                 |      | 6:55   |       | 7:10 |         | 7:25                |      |  | 7:30     |
|                   | <b>Stage Change</b>             |          | <b>Stage Change</b> |      |        |       |      |         | <b>Stage Change</b> |      |  |          |
|                   | Winners Circle                  | Onsite   | Onsite              |      | Onsite |       | 7:20 |         | 7:50                |      |  | 7:55     |

# 2024 Quartet Competition Traffic Pattern – Region #3

Similar to International competitions, we will be utilizing Convention Assistants to move contestants through the pattern.

## **Check In & Busing**

The official pattern will begin in the Hilton. Convention assistants will guide you through each step of the process. A hotel diagram is attached. Please do not arrive more than 10 minutes early as space is limited.

At the appropriate time, the convention assistants will escort you to your bus. You will be going outside to load the bus.

To ensure contestants will be able to enter the Miller High Life Theater (MHLT), badges will have to be displayed to board the buses. Please keep badges with each member until you are inside the theater.

Quartets will arrive at the back of the MHLT. A MHLT diagram is attached. Quartets are asked to keep noise levels low as the sound may carry to the stage. After unloading from the bus, quartets will be directed to a holding area. Quartet photos will be taken in the holding area by Read Photography.

## **Warm-Up Room**

At the appropriate time, you will be escorted to warm-up. You will have 10 minutes in warm-up and timing begins when the last member enters the room. No extra time will be allowed for late arrivals or those stopping to use the facilities. Convention staff will give you a 2 minute notice before asking you to move out of the room. Please be ready to move when they return.

## **Stage**

From warm-up, you will be led to the backstage doors. As you leave warm-up, please keep the noise to a bare minimum as sound will carry to the stage.

Stage doors will be opened by convention staff. Convention staff will take your purse bag while you compete. Those on a scooter or in a wheel chair should enter first. Convention staff will direct them on where to park. Parking is a good distance from the stage entrance. You may want to consider having the scooter member unload at the entrance and have a more mobile member drive the scooter to the parking area.

Quartets may enter stage right or center stage. The stage will have a curtain (mid-stage). Convention staff will be on hand to open the curtain for those selecting a center stage entrance. All quartets will exit stage left. You will be lead out of backstage and your purse bag will be returned.

## **Items of Note**

To be fair to all contestants, singing is only allowed in warm-up and on the stage. Your cooperation is appreciated.

If someone has a scooter or wheel chair in the pattern, please note that the Convention Committee, Convention Assistants nor the RMT can assist in moving either a scooter or a wheel chair.

Chairs will be available in all areas of the pattern for those who need to sit.

Score sheets will be available for pick up at the MHLT for 15 minutes following the end of awards. Please proceed to the front of the stage – just right of the judging area.

MAP DOWNTOWN MILWAUKEE

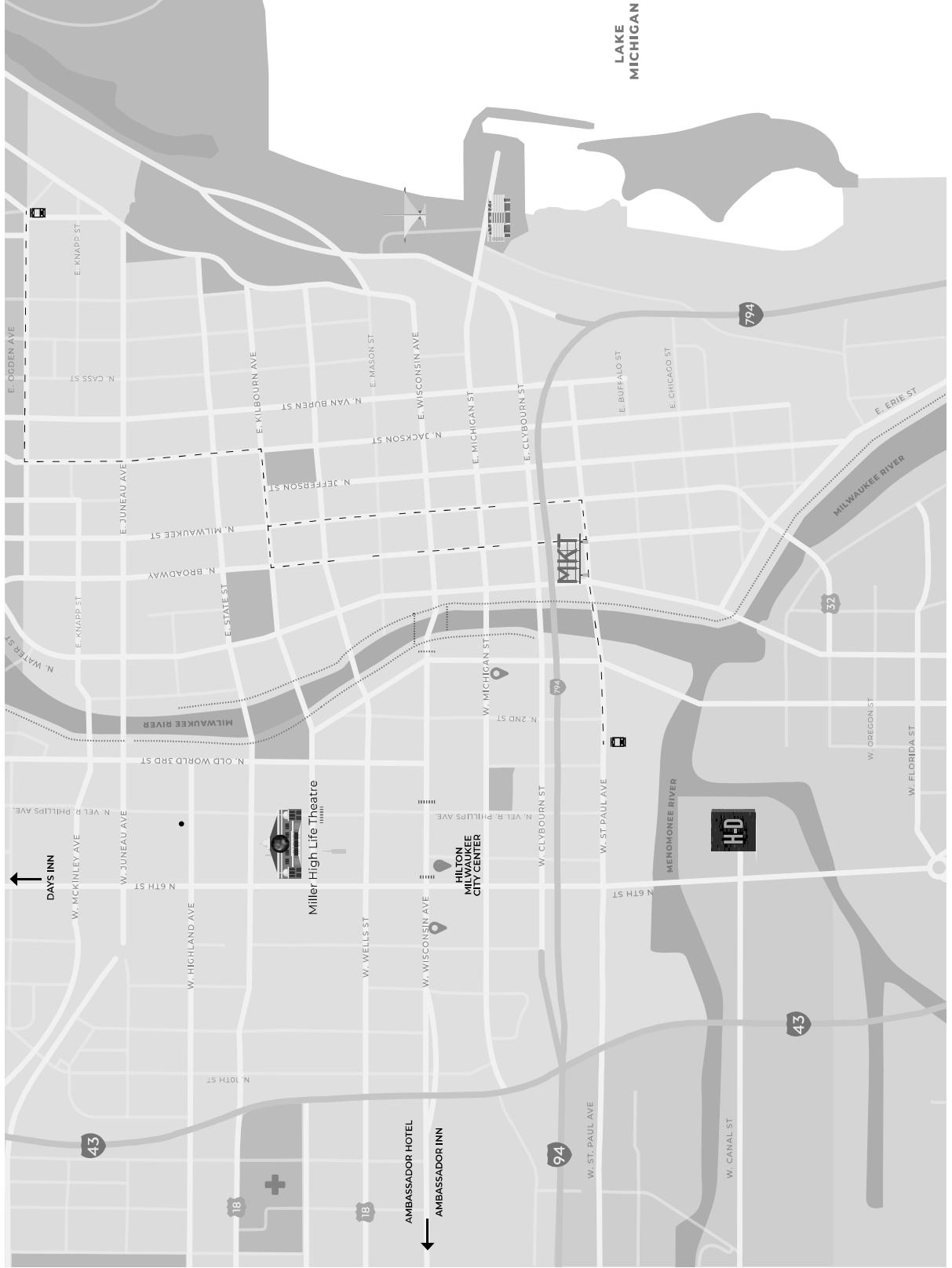

# Hilton Milwaukee City Center

## LOBBY LEVEL

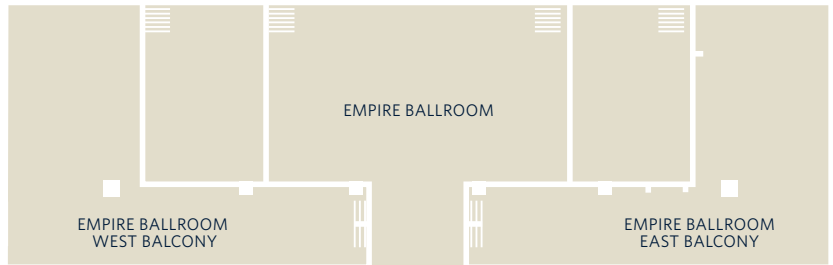

**CONTESTANT CHECK IN**  
(behind front desk - near escalators)

**MAIN LOBBY**



## 4TH FLOOR

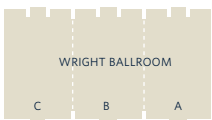

**R  
E  
G  
I  
S  
T  
R  
A  
T  
I  
O  
N**



# Hilton Milwaukee City Center

## 5TH FLOOR

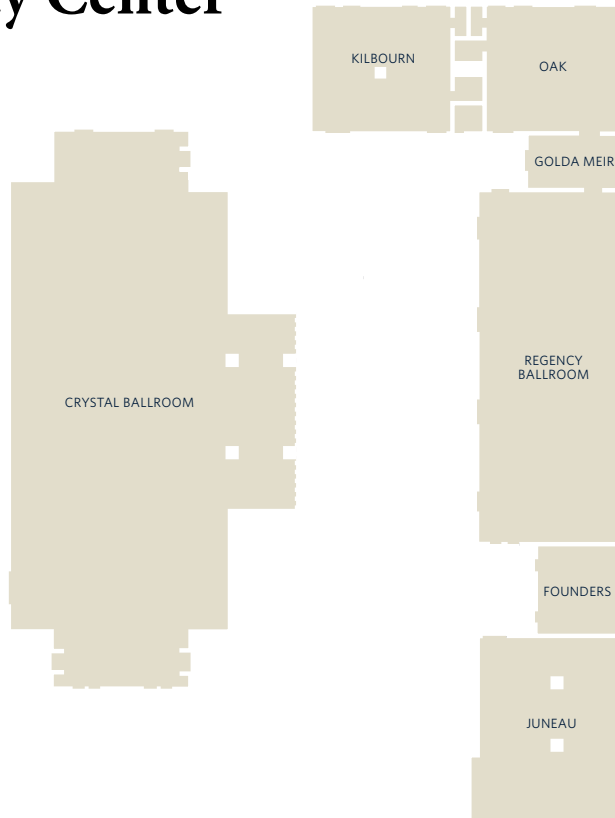

### 4th Floor

**Registration & Sales**

**Briefing (Wright Ballroom)**

**Education Class (Wright Ballroom)**

### Chorus Meeting Rooms

**Choral-Aires - Regency (Fri), Crystal (Sat day) & Wright C (Sat evening)**

**Crosstown Harmony - Oak**

**Great Lake Sound - Walker**

**Heart of Illinois - Mitchell**

**Melodeers - Empire (Fri & Sat day) & Wright B (Sat evening)**

**Midwest Crossroad - Wright A & B (Fri & Sat day) & Wright A (Sat evening)**

**Riverport - Kilbourn**

**Vermillion Valley Show - MacArthur**



KILBOURN AVE.

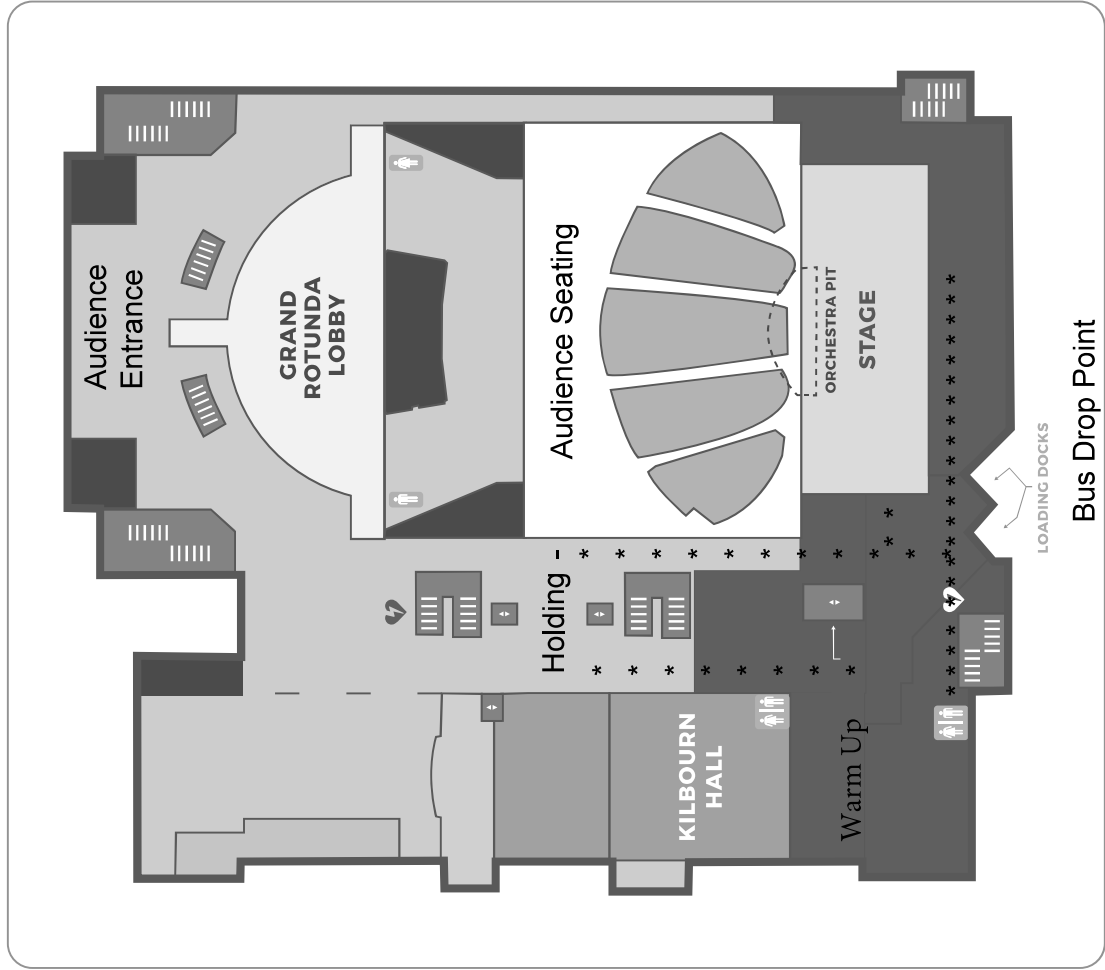

6TH ST.

Audience will enter via the Kilbourn Ave entrance.

Ticket Sales, Chorus Raffles and Concessions will be just as you enter from Kilbourn Ave.

**Pattern**

Contestants will enter behind the stage through the loading docks. They will walk straight forward to the holding area and then in to Kilbourn Hall.

From Kilbourn Hall, contestants will move to warm up. After a 10 minute warm up, contestants will be moved to backstage and then to the stage.

After competing, contestants will walk back up the hall to the audience seating