

# MAIN LEVEL FLOOR PLAN

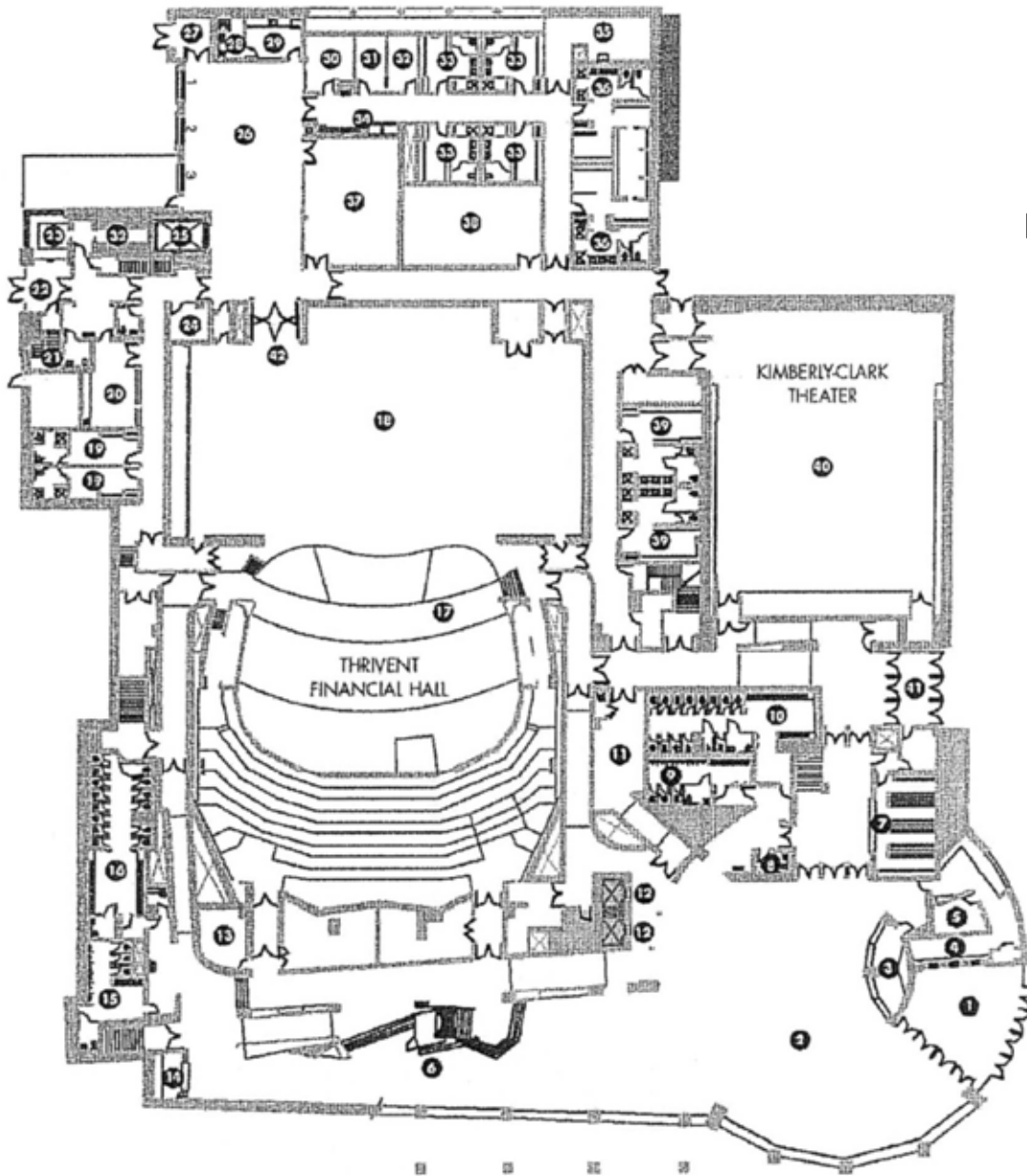

DIAGRAM B

## SITE MAP KEY

- |                                  |   |   |  |
|----------------------------------|---|---|--|
| 1. Front Entrance                | 11. Catering Kitchen                    | 22. Stage Door                          | 33. Four Person Dressing Room                      |
| 2. Main Lobby                    | 12. Passenger Elevators                 | 23. Security Desk                       | 34. Vending Machine                                |
| 3. Bar                           | 13. House Manger's Office               | 24. Technical Stage Manager's Office    | 35. Laundry Room                                   |
| 4. Ticket Service Area           | 14. Bar                                 | 25. Service/Accessibility Elevator      | 36. Chorus Dressing Room with restroom and showers |
| 5. Ticket Office                 | 15. Men's West Public Restroom          | 26. Loading Dock Area                   | 37. Catering, Hair, Props or Storage               |
| 6. Information Desk              | 16. Women's West Public Restroom        | 27. Trash Room                          | 38. Storage (unavailable)                          |
| 7. East Coatroom                 | 17. Audience Chamber Orchestra Level    | 28. Crew Restroom                       | 39. Studio Theater Dressing Room                   |
| 8. Public Restroom               | 18. Stage                               | 29. Stagehand Crew Room                 | 40. Studio Theater Main Level                      |
| 9. Men's East Public Restroom    | 19. Stars' Dressing Rooms               | 30. Director's Office                   | 41. Division Street/Valet Entrance                 |
| 10. Women's East Public Restroom | 20. Green Room                          | 31. Scheduling Coordinator's Office     | 42. Load In Doors<br>12'7" wide x 11'10" high      |
|                                  | 21. Exit Stair Down from Administration | 32. Visiting Production/Company Offices |  |