

MIDWEST HARMONY

Region 3

The logo for Midwest Harmony Region 3 features the words "MIDWEST" and "HARMONY" in a large, bold, black sans-serif font. "MIDWEST" is on the top line and "HARMONY" is on the bottom line. The word "HARMONY" is partially overlaid by a musical staff. The staff has a treble clef on the right and a bass clef on the left. There are four notes on the treble staff (G4, A4, B4, C5) and four notes on the bass staff (F3, G3, A3, B3). The word "Region 3" is written in a black, cursive script font below "HARMONY".

Regional Convention and Competition
May 4 – 7, 2023 – Milwaukee, Wisconsin

March 20, 2023

To: Competing Quartets
Regional Management Team

From: Convention Steering Committee

RE: Convention Mailing #3 - Quartet

Enclosures

1. Competition Information
2. Traffic Pattern & Information



Convention & Competition
May 4 – 7, 2023

Convention Mailing #3 - Quartet

Enclosed you will find important meeting times and locations, and the Quartet traffic pattern. Please review this information carefully.

Thursday, May 4, 2023

- 7:00 pm Briefing Check in – Wright Ballroom**
Review forms for changes
Turn in Cue Sheets (Open Division)
Receive awards information
Purse Bags will be distributed (all are required to use Purse Bags)
- 7:30 pm Quartet/Chorus Briefing – Wight Ballroom**
Contest details will be reviewed so everyone understands the rules and has an opportunity to ask questions
Briefing should be completed by 8:30 pm

Friday, May 5, 2023

- 8:30 am Traffic Pattern Walk-Through – Miller High Life Theater Lobby**
Quartets are invited to walk through the traffic pattern with the chorus leaders. We will meet in the lobby, walk the pattern and end on the stage for the sound check.
- 8:30 am Sound Check Chorus & Quartet – Miller High Life Theater**
All quartets are invited to participate. We will be singing *Send Your Love* and *How We Sang Today*. Amy Brinkman & Bonnie Fedyski will be directing. Once the chorus sound check is complete, we will begin the quartet check. PRISM will be testing the stage.
- Quartet Walk-On – Miller High Life Theater**
Begins after Sound Check is finished
All quartets will be announced, enter the stage, take a pitch, sing the first few notes of a song and exit
- Note: Visit Milwaukee volunteers will be on the sidewalks to help direct everyone from the hotel to the theater.
- 4:00 pm Quartet Contest will begin promptly at 4:00 pm**
2022 Quartet Champions, PRISM, will be competing for evaluation and performing a swan song. Following their swan song, the Winner's Circle will perform. Details regarding awards will be explained at the Briefing

Saturday, May 6, 2023

- 12:00 pm Chorus Contest will begin promptly at 12:00 pm**



Convention & Competition
May 4 – 7, 2023
Convention Mailing #3

Open Division Contestants – The stage will have a center stage microphone. Please be sure to indicate your emcee work on your cue sheet so the tech crew will know when to have the microphone on for you. As a reminder, our region only offers white lights on stage.

We hope none of you will have to withdraw from the contest. If your quartet does have to withdraw prior to convention weekend, please contact Competition Services at the Sweet Adelines office in Tulsa. If your quartet needs to withdraw after arriving in Milwaukee, please notify Michelle Adams immediately. She can be reached via cell phone at 815-530-3969. If she is unavailable, you may contact Shelly Hughes via cell phone at 312-209-4533.

Tickets – Tickets (Badges) are needed to enter the theater. If you leave the theater, you will be required to show your badge to re-enter. Refer to the Schedule of Events for ticket sales and badge pick up times and locations.

2023 Quartet Contest - Region #3

Number	Quartet Name	Check-in		Load		Photo		Warm		Back		ON STAGE
		Time		Bus		Room	Up	Stage	Stage			
Welcome	Emcee											4:00
MT	PRISM	3:10		3:15		3:35		3:50		4:05		4:10
1	Spare Parts - Open	3:22		3:27		3:47		4:02		4:17		4:22
2	Cool Beans	3:36		3:41		4:01		4:16		4:31		4:36
3	Livestream	3:48		3:53		4:13		4:28		4:43		4:48
4	Charisma! - Open	4:00		4:05		4:25		4:40		4:55		5:00
5	By Request	4:14		4:19		4:39		4:54		5:09		5:14
6	4Frenz	4:26		4:31		4:51		5:06		5:21		5:26
7	Chicago Mix	4:38		4:43		5:03		5:18		5:33		5:38
	Intermission			Intermission						Intermission		
	Golden Girl Presentation											6:20
8	Whimsy	5:40		5:45		6:05		6:20		6:35		6:40
9	Humdingers	5:52		5:57		6:17		6:32		6:47		6:52
10	Stiletto	6:04		6:09		6:29		6:44		6:59		7:04
11	On A Whim	6:16		6:21		6:41		6:56		7:11		7:16
12	PRISM - Eval Only	6:28		6:33		6:53		7:08		7:23		7:28
SS	Prism	N/A		N/A		N/A		N/A		7:35		7:40
	Stage Change			Stage Change						Stage Change		
	Winners Circle	N/A		N/A		N/A		7:25		7:50		8:00

2023 Quartet Competition Traffic Pattern – Region #3

Similar to International competitions, we will be utilizing Convention Assistants to move contestants through the pattern.

Check In & Busing

The official pattern will begin in the Hilton. Convention assistants will guide you through each step of the process. A hotel diagram is attached. Please do not arrive more than 10 minutes early as space is limited.

At the appropriate time, the convention assistants will escort you to your bus. You will be going outside to load the bus.

To ensure contestants will be able to enter the Miller High Life Theater (MHLT), badges will have to be displayed to board the buses. Please keep badges with each member until you are inside the theater.

Quartets will arrive at the back of the MHLT. A MHLT diagram is attached. Quartets are asked to not talk while backstage as the noise may carry to the stage. After unloading from the bus, quartets will be directed to a holding area. Quartet photos will be taken in the holding area. Read Photography is our photographer.

Warm-Up Room

At the appropriate time, you will be escorted to warm-up. You will have 10 minutes in warm-up and timing begins when the last member enters the room. No extra time will be allowed for late arrivals or those stopping to use the facilities. Convention staff will give you a 2 minute notice before asking you to move out of the room. Please be ready to move when they return.

Stage

From warm-up, you will be led to the backstage doors. As you leave warm-up, please keep the noise to a bare minimum as all noise will carry to the stage.

Stage doors will be opened by convention staff. Convention staff will take your purse bag while you compete. Those on a scooter or in a wheel chair should enter first. Convention staff will direct them on where to park. Parking is a good distance from the stage entrance. You may want to consider having the scooter member unload at the entrance and have a more mobile member drive the scooter to the parking area.

Quartets may enter stage right or center stage. The stage will have a curtain (mid-stage). Convention staff will be on hand to open the curtain for those selecting a center stage entrance. All quartets will exit stage left. You will be lead out of backstage and your purse bag will be returned.

Items of Note

To be fair to all contestants, singing is only allowed in warm-up and on the stage. Your cooperation is appreciated.

If someone has a scooter or wheel chair in the pattern, please note that the Convention Committee, Convention Assistants nor the RMT can assist in moving either a scooter or a wheel chair.

Chairs will be available in all areas of the pattern for those who need to sit.

Score sheets will be available for pick up at the MHLT for 15 minutes following the end of awards. Please proceed to the front of the stage – just right of the judging area.

MAP DOWNTOWN MILWAUKEE

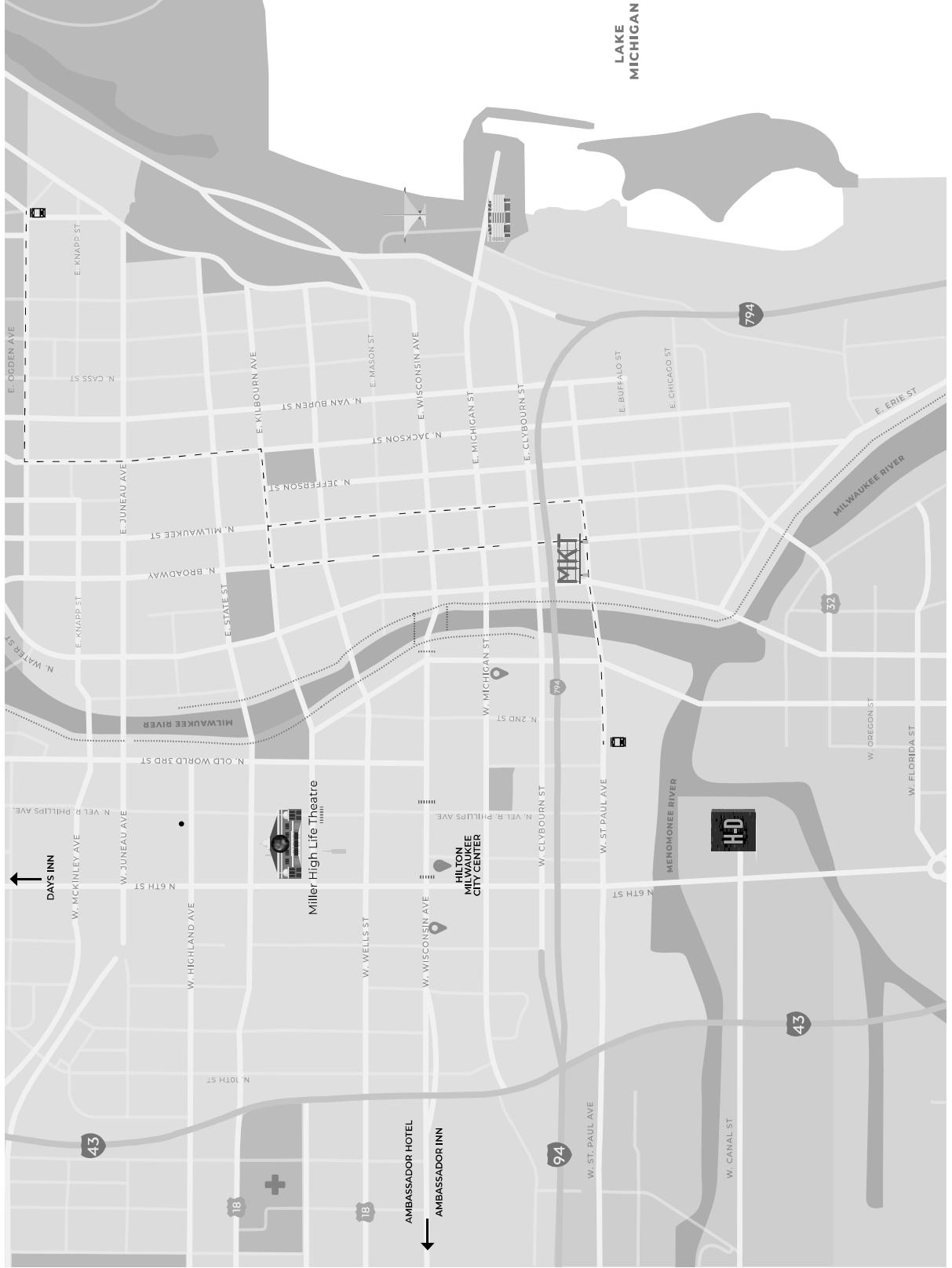

Hilton Milwaukee City Center

LOBBY LEVEL

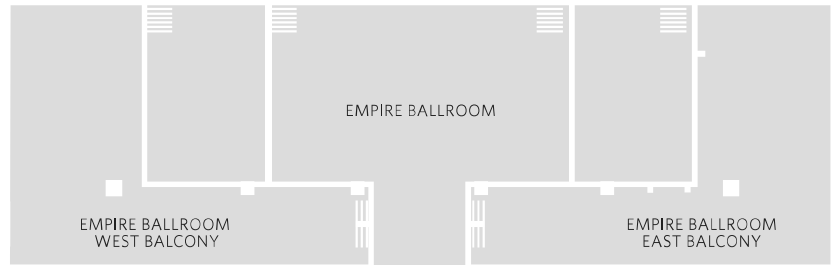

CONTESTANT CHECK IN
(behind front desk - near escalators)

MAIN LOBBY

MONARCH LOUNGE

4TH FLOOR

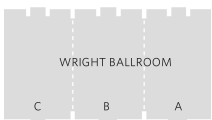

R
E
G
I
S
T
R
A
T
I
O
N

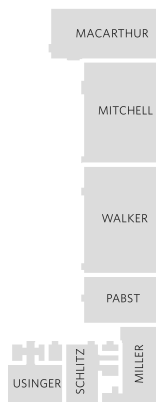

Hilton Milwaukee City Center

5TH FLOOR

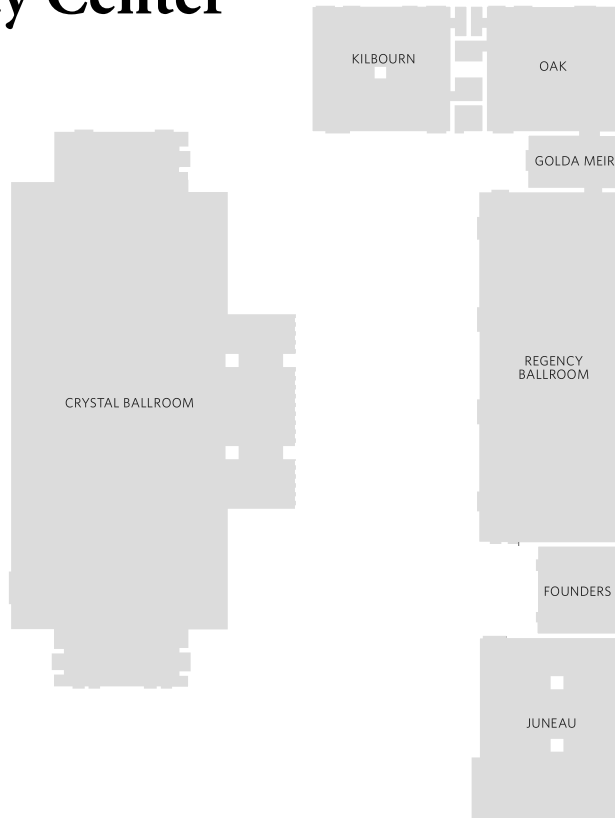

Lobby Level

Winner Circle Reception
(Empire Ballroom)

4th Floor

Registration & Sales
Briefing (Wright Ballroom)
Education Class (Wright Ballroom)

Chorus Meeting Rooms

Choral-Aires - Regency Ballroom (5th Floor)
Crosstown Harmony - Walker (4th Floor)
Great Lake Sound - Kilbourn (5th Floor)
Heart of Illinois - Mitchell (4th Floor)
Melodeers - Crystal Ballroom (5th Floor)
Midwest Crossroad - Juneau (5th Floor)
River City Sound - Wright Ballroom C (4th Floor)
Riverport - Wright Ballroom A (4th Floor)
Toast of Champaign - McArthur (4th Floor)
Vermillion Valley Show - Oak (5th Floor)
Yahara River - Pabst (4th Floor)

KILBOURN AVE.

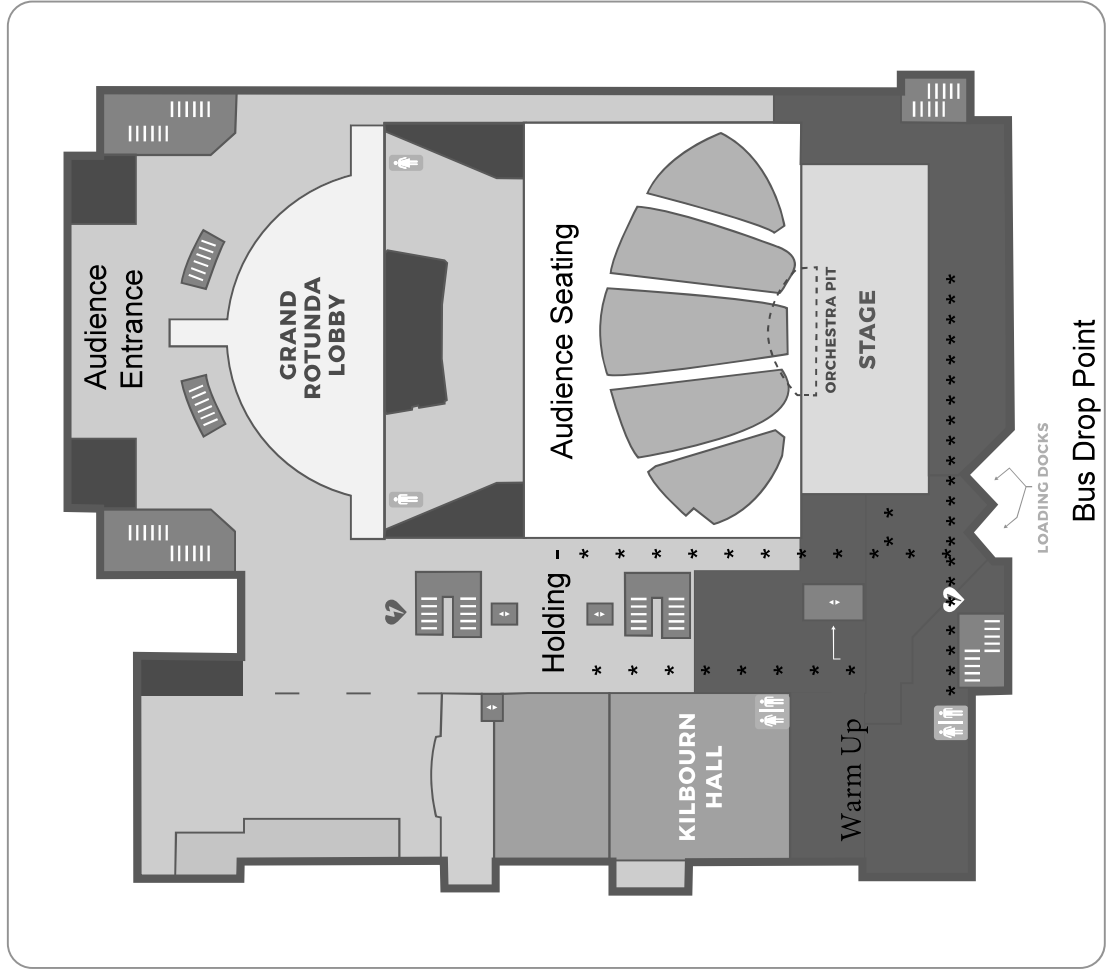

6TH ST.

Audience will enter via the Kilbourn Ave entrance.

Ticket Sales, Chorus Raffles and Concessions will be just as you enter from Kilbourn Ave.

Pattern

Contestants will enter behind the stage through the loading docks. They will walk straight forward to the holding area and then in to Kilbourn Hall.

From Kilbourn Hall, contestants will move to warm up. After a 10 minute warm up, contestants will be moved to backstage and then to the stage.

After competing, contestants will walk back up the hall to the audience seating