

MIDWEST HARMONY *Region 3*

The logo features the words 'MIDWEST' and 'HARMONY' in large, bold, black, sans-serif capital letters. 'MIDWEST' is on the top line, and 'HARMONY' is on the bottom line. The word 'Region 3' is written in a black, cursive script font below 'HARMONY'. The text is integrated with musical notation: a treble clef and a G-clef are on the right side of the top staff, with a G4 note, an A4 note, and a B4 note. A bass clef and a B-clef are on the left side of the bottom staff, with a B2 note, a C3 note, a D3 note, and an E3 note.

Regional Convention and Competition
April 2 – 5, 2020 – Appleton, Wisconsin

February 24, 2020

To: Competing Quartets
Regional Management Team

From: Convention Steering Committee

RE: Convention Mailing #3 - Quartet

Enclosures

1. Competition Information
2. Traffic Pattern & Information



Convention & Competition
April 2 – 5, 2020

Convention Mailing #3 - Quartet

Enclosed you will find important meeting times and locations, and the Quartet traffic pattern. Please review this information carefully.

Committee Update - Brenda Bowman has had to step down from the CC position for family medical reasons. Shelly Hughes & Cindy Slowik will be covering the role.

Thursday, April 2, 2020

- 7:00 pm Briefing Check in** – Grand Ballroom A & B
Review forms for changes
Turn in Cue Sheets (Open Division)
Receive awards information
Purse Bags will be distributed (all are required to use Purse Bags)
- 7:30 pm Quartet/Chorus Briefing** – Grand Ballroom A & B
Contest details will be reviewed so everyone understands the rules and has an opportunity to ask questions
Briefing should be completed by 8:30 pm

Friday, April 4, 2020

- 8:30 am Traffic Pattern Walk-Through** – PAC Lobby
Quartet Sound Check will be first, then chorus
Competing quartets **ONLY** are invited to walk through the traffic pattern. Please note that we will meet in the PAC
- 9:30 am Quartet Walk-On** – Thrivent Financial Theater, PAC
Time is approximate – begins after Sound Check is finished
All quartets will be announced, enter the stage, take a pitch, sing the first few notes of a song and exit
- 10:00 am Sound Check Chorus** – Thrivent Financial Theater, Fox Valley PAC
All chorus members and directors are invited to participate. We will be singing *Send Your Love* and *How We Sang Today*. Joan Boutilier will be directing. During the chorus sound checks, directors will be able to stand near Joan; however, only Joan will be able to direct. Please encourage your members to participate in the Sound Check Chorus
- 4:00 pm Quartet Contest will begin promptly at 4:00 pm**
2019 Quartet Champions, Prism, will be performing swan song set following the last contestant. Following the swan song, the Winner's Circle will perform. Details regarding awards will be explained at the Briefing

Saturday, April 4, 2020

- 12:00 pm Chorus Contest will begin promptly at 12:00 pm**



Convention & Competition
April 2 – 5, 2020
Convention Mailing #3

Open Division Contestants – The stage will have a center stage microphone. Please be sure to indicate your emcee work on your cue sheet so the tech crew will know when to have the microphone on for you. As a reminder, our region only offers white lights on stage.

We hope none of you will have to withdraw from the contest. If your quartet does have to withdraw prior to convention weekend, please contact Competition Services at the Sweet Adelines office in Tulsa. If your quartet needs to withdraw after arriving in Appleton, please notify Shelly Hughes immediately. She can be reached via cell phone at 312-209-4533. If she is unavailable, you may contact Cindy Slowik via cell phone at 815-545-3617.

Tickets – Tickets (Badges) are needed to enter the theater. If you leave the PAC, you will be required to show your badge to re-enter the PAC. As a reminder, tickets will not be sold within the PAC. Refer to the Schedule of Events for ticket sales and badge pick up times and locations.

2020 Quartet Contest - Region #3

Contestant Number	Contestant Name	Check-in Time	Photo Room Arrive	Load Bus	Warm Up Arrive	Back Stage	ON STAGE
Welcome	Emcee						
MT	Martini	3:10	3:15	3:30	3:50	4:05	4:00
1	Spare Parts - OPEN	3:21	3:26	3:41	4:01	4:16	4:21
2	Chordially Yours - OPEN	3:35	3:40	3:55	4:15	4:30	4:35
3	To The Max	3:49	3:54	4:09	4:29	4:44	4:49
4	Sweet & Salty - OPEN	4:00	4:05	4:20	4:40	4:55	5:00
5	Whimsy	4:14	4:19	4:34	4:54	5:09	5:14
6	Humdingers	4:25	4:30	4:45	5:05	5:20	5:25
7	PRISM	4:36	4:41	4:56	5:16	5:31	5:36
8	Stiletto	4:47	4:52	5:07	5:27	5:42	5:47
	Intermission		Intermission			Intermission	
	Golden Girl Presentation						6:30
9	Chicago Mix	5:45	5:50	6:05	6:25	6:40	6:45
10	Drive Time	5:56	6:01	6:16	6:36	6:51	6:56
11	Cool Beans	6:07	6:12	6:27	6:47	7:02	7:07
12	Hot Mess	6:18	6:23	6:38	6:58	7:13	7:18
13	Odyssey	6:29	6:34	6:49	7:09	7:24	7:29
14	By Request	6:40	6:45	7:00	7:20	7:35	7:40
	Stretch Break		Stretch Break			Stretch Break	
SS	PRISM	Onsite	Onsite	Onsite	7:40	7:55	8:00

2020 Quartet Contest Traffic Pattern – Region #3

Similar to International competitions, we will be utilizing Convention Assistants to move contestants through the pattern.

Note: To be fair to all competitors, singing is only allowed in the warm-up rooms. Your cooperation is appreciated.

Check In & Busing

The official pattern will begin in the Red Lion lobby. At check in, you will be introduced to your quartet escort. She will guide you to the stage. A diagram of the hotel layout is attached.

After check in, your quartet will move to the photo area. Read Photography is our photographer. After photos, you will return to the lobby.

At the appropriate time, the convention assistants will escort you from lobby to your bus. This is a small, handicapped accessible bus. You will be going outside to load the bus.

Due to heightened security measures at the PAC, only contestants, convention assistants and convention staff will be allowed back stage. Contestants must display their all events badge to enter warm-up. To ensure contestants will be able to enter the PAC, badges will have to be displayed to board the buses. Please keep badges with each member until you are inside the photo room – then place them in purse bags.

Quartets will arrive at the PAC and enter through the valet entrance. A PAC diagram is attached.

Warm-Up Room

After entering the PAC, you will be escorted to warm-up. You will be given at least 10 minutes in warm-up and timing begins when the last member enters the room*. Convention staff will give you a 2 minute notice before asking you to move out of the room. Please be ready to move when they return.

* No extra time given for late arrivals or those stopping to use the facilities.

Stage

From warm-up, you will be led to the backstage doors. As you leave the warm-up room, please keep the noise to a bare minimum as all noise will carry to the stage.

Stage doors will be opened by convention staff. Your quartet escort will hold your purse bag while you compete. Those on a scooter or in a wheel chair should enter first. Convention staff will direct them on where to park.

Quartets may enter stage right or center stage. The stage will have a curtain (mid-stage). Convention staff will be on hand to open the curtain for those selecting a center stage entrance. All quartets will exit stage left. Your quartet escort will meet you as you exit. The escort will lead you back to the PAC lobby and return your purse bag. You will then be escorted to the webcast booth to be interviewed.

Items of Note

If someone has a scooter or wheel chair in the pattern, please note that the Convention Committee, Convention Assistants nor the RMT can assist in moving either a scooter or a wheel chair.

Score sheets will be available for pick up at the PAC for 15 minutes following the end of the contest. Please proceed to the auditorium lobby. Only a member of the quartet is allowed to pick up the score sheet packet.

DOWNTOWN APPLETON MAP

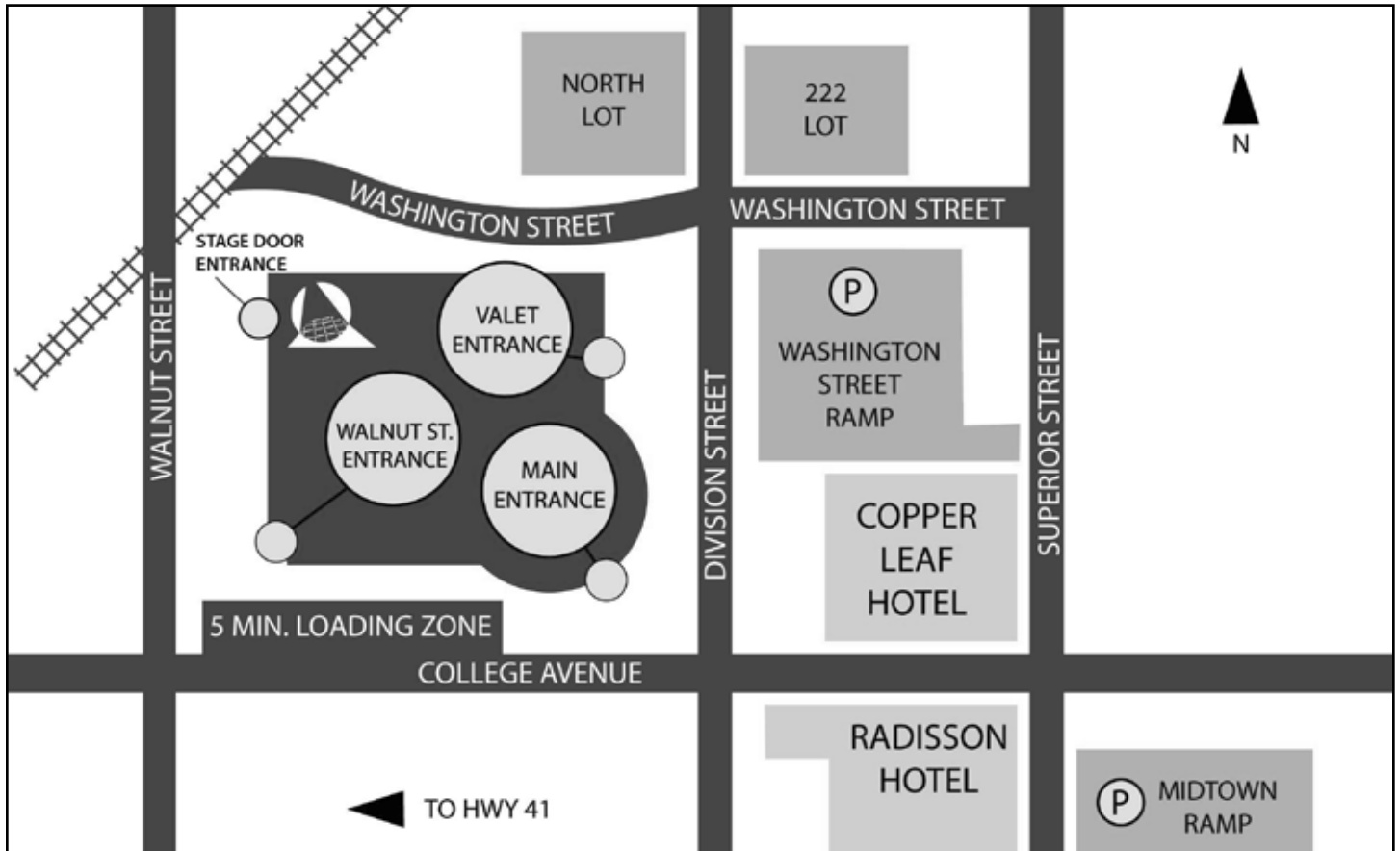

DIAGRAM E

Quartets exit hotel on College
 Board bus on Superior - drive to PAC
 Enter PAC at Valet Entrance

MAIN LEVEL FLOOR PLAN

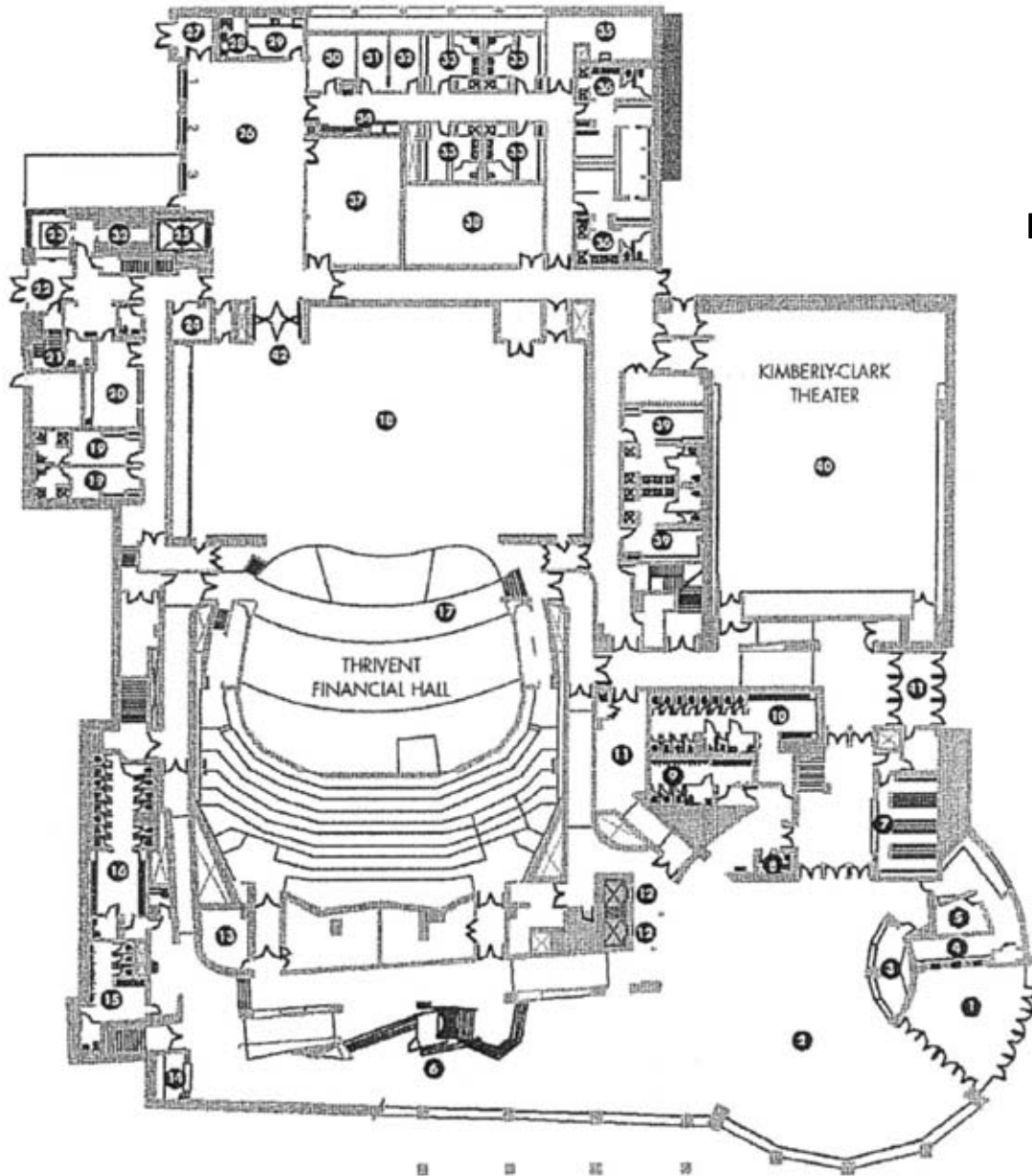

DIAGRAM B

SITE MAP KEY

- | | | | |
|----------------------------------|---|---|--|
| 1. Front Entrance | 11. Catering Kitchen | 22. Stage Door | 33. Four Person Dressing Room |
| 2. Main Lobby | 12. Passenger Elevators | 23. Security Desk | 34. Vending Machine |
| 3. Bar | 13. House Manger's Office | 24. Technical Stage Manager's Office | 35. Laundry Room |
| 4. Ticket Service Area | 14. Bar | 25. Service/Accessibility Elevator | 36. Chorus Dressing Room with restroom and showers |
| 5. Ticket Office | 15. Men's West Public Restroom | 26. Loading Dock Area | 37. Catering, Hair, Props or Storage |
| 6. Information Desk | 16. Women's West Public Restroom | 27. Trash Room | 38. Storage (unavailable) |
| 7. East Coatroom | 17. Audience Chamber Orchestra Level | 28. Crew Restroom | 39. Studio Theater Dressing Room |
| 8. Public Restroom | 18. Stage | 29. Stagehand Crew Room | 40. Studio Theater Main Level |
| 9. Men's East Public Restroom | 19. Stars' Dressing Rooms | 30. Director's Office | 41. Division Street/Valet Entrance |
| 10. Women's East Public Restroom | 20. Green Room | 31. Scheduling Coordinator's Office | 42. Load In Doors
12'7" wide x 11'10" high |
| | 21. Exit Stair Down from Administration | 32. Visiting Production/Company Offices | |